



Kung Fu Panda™ 3-D Paper Character

# Master Monkey

## ASSEMBLY INSTRUCTIONS

Time to Complete: Approximately 60 minutes

Level: Difficult

### GETTING STARTED

#### Materials:

- Metal-edged ruler
- Butter knife
- Scissors or X-ACTO knife
- Cutting mat (optional)
- Hole punch
- Multipurpose glue
- 1 brad

1. Score all the pieces: Using a ruler as a guide, run the back side of a butter knife firmly along all the dotted lines.



2. Using scissors or an X-ACTO knife and cutting mat, cut out all pieces along the solid lines. Cut slits where indicated on face, arms and snout.



### ASSEMBLE THE SNOOT AND FACE

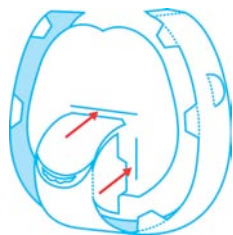

3. Fold snout (1) tabs A and B back and insert into slits in face (2) as shown. Insert top of snout into slit as shown.

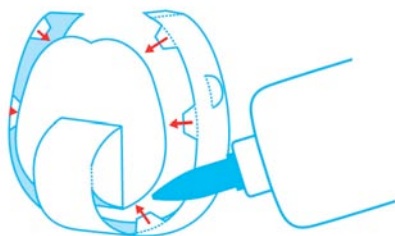

4. Pop out ears, and fold small tabs backward on strip. Starting at the chin and working upward, glue tabs in place behind the face.

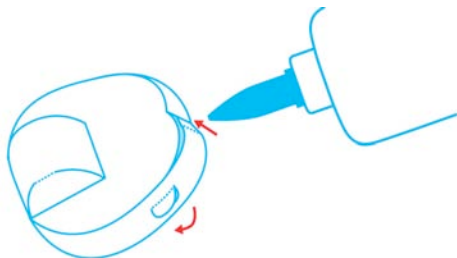

5. Tuck the top tab under adjacent edge and glue in place.

## ASSEMBLE THE BODY

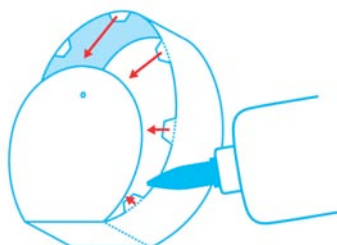

6. Fold body (3) flaps and tabs inward on dotted lines. Curve tabbed piece around and glue tabs in place behind the front of the body.

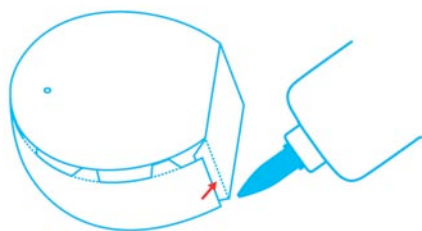

7. Tuck the bottom tab under the adjacent edge and glue in place.

## ASSEMBLE THE HEAD

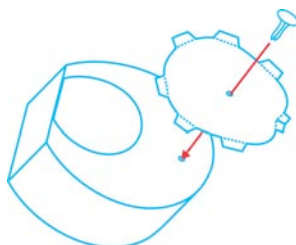

8. Insert a brad through the unprinted side of the back of head (4) so it emerges where marked on the printed side. Then, insert the brad through the mark indicated on the body, and open the brackets, securing the head to the body.

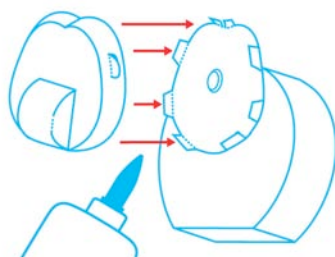

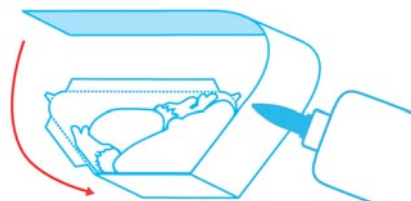

9. Place a dab of glue on the remaining tabs on back of the head. Attach the face to the back of head by placing it carefully over each tab as shown.

## ASSEMBLE THE LEGS AND TAIL

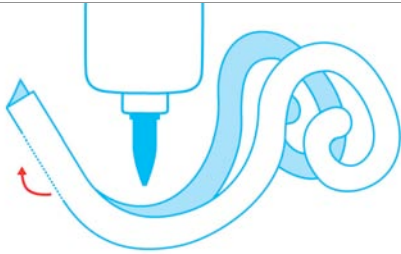

10. On the legs piece (5), fold all tabs and flaps in on dotted lines. Curve band around and glue to all tabs on side with leg art, leaving the other side open.

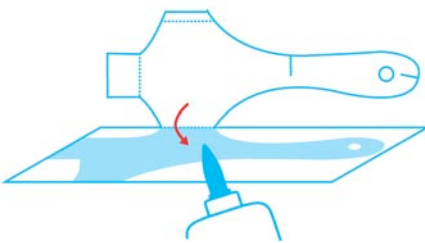
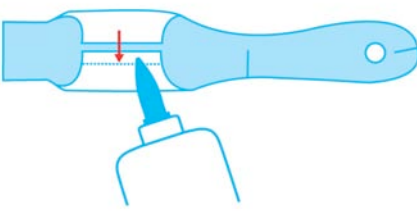
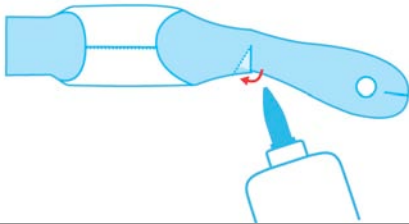
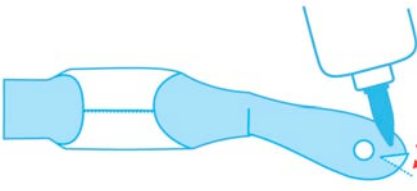
	<p>11. Fold tail (6) in half and glue together.</p>
	<p>12. Insert end of tail through slit in back of legs and glue in place. Next, glue tabs to seal up legs.</p>
<b>ASSEMBLE THE ARMS</b>	
	<p>13. Fold each arm (7) in half against its rectangle and glue together. Cut out along the solid lines of arm shape.</p>
	<p>14. Punch a hole in each hand where marked. Next, curve arm flaps around and glue where marked.</p>
	<p>15. Pull cut in hand over to meet dotted line and glue in place.</p>
	<p>16. Pull cut in arm over to meet dotted line and glue in place.</p>

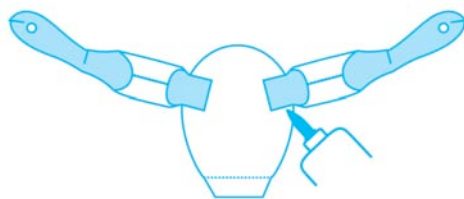

17. Glue arm tabs to inside of back piece.

## ASSEMBLE THE BACK

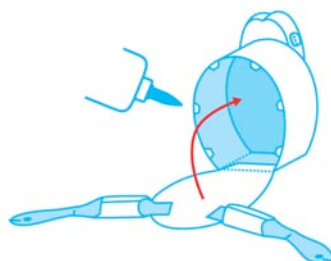

18. Place a dab of glue on the tab at the bottom of back (8) piece. Then pull back up and glue to small tabs along body.

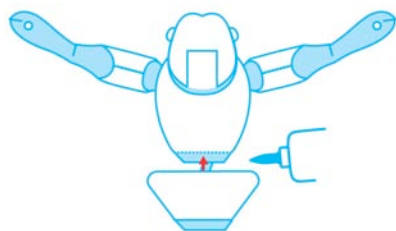

19. Glue body to legs as shown.



20. Fold the rod (9) in half and glue together.

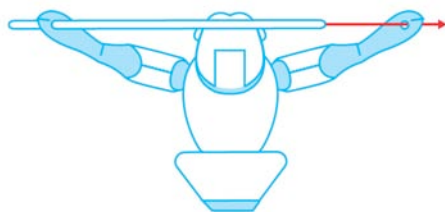

21. Stick rod through the punched holes in each hand. You're done!